



PROVINCE OF THE EASTERN CAPE  
IPHONDO LEMPUMA KOLONI  
PROVINSIE OOS-KAAP

**Provincial Gazette  
Igazethi Yephondo  
Provinsiale Koerant  
Extraordinary**

Vol: 32

BISHO/KING WILLIAM'S TOWN

28 October 2025  
28 Oktober 2025

**No: 5524**

**We all have the power to prevent AIDS**



**Prevention is the cure**

**AIDS  
HELPLINE**

**0800 012 322**

DEPARTMENT OF HEALTH

*N.B. The Government Printing Works will not be held responsible for the quality of "Hard Copies" or "Electronic Files" submitted for publication purposes*

ISSN 1682-4555



9 771682 455006



0 5 5 2 4

**IMPORTANT NOTICE:**

**THE GOVERNMENT PRINTING WORKS WILL NOT BE HELD RESPONSIBLE FOR ANY ERRORS THAT MIGHT OCCUR DUE TO THE SUBMISSION OF INCOMPLETE / INCORRECT / ILLEGIBLE COPY.**

**No FUTURE QUERIES WILL BE HANDLED IN CONNECTION WITH THE ABOVE.**

**Contents**

| <i>No.</i> |  | <i>Gazette<br/>No.</i> | <i>Page<br/>No.</i> |
|------------|--|------------------------|---------------------|
|            | <b>PROVINCIAL NOTICES • PROVINSIALE KENNISGEWINGS</b>  |                        |                     |
| 1400       | The National Environmental Management: Protected Areas Act, 2003 (57/2003): Declaration of various Nature Reserves in terms of section 23(1) of the Act..... | 5524                   | 3                   |

**PROVINCIAL NOTICES • PROVINSIALE KENNISGEWINGS****PROVINCIAL NOTICE 1400 OF 2025****ECONOMIC DEVELOPMENT, ENVIRONMENTAL AFFAIRS AND TOURISM FOR  
THE EASTERN CAPE PROVINCE****NOTICE OF INTENTION TO DECLARE A NATURE RESERVE IN TERMS OF THE NATIONAL  
ENVIRONMENTAL MANAGEMENT: PROTECTED AREAS ACT, 2003 (ACT 57 OF 2003)**

I, Nonkqubela Ntomboxolo Pieters, Member of the Executive Council (MEC) for Economic Development, Environmental Affairs and Tourism in the Province of the Eastern Cape, by virtue of the powers vested in me under section 32 and section 33 of the National Environmental Management: Protected Areas Act, 2003 (Act No. 57 of 2003) ("the Act"), hereby give notice of my intention to declare the properties described in the Schedule hereunder as a Nature Reserve in terms of section 23(1) of the Act.

Members of the public, as well as interested and affected parties, are invited to submit written representations on or objections to the intention within 60 days after the publication of this notice in the Gazette, to the following address:

By Post:           The Chief Executive Officer  
                      Eastern Cape Parks and Tourism Agency  
                      P.O. Box 11235  
                      Southernwood  
                      East London  
                      5213

By Hand:          The Chief Executive Officer  
                      Eastern Cape Parks and Tourism Agency  
                      17-25 Oxford Street, East London CBD, 5201

By Email:         [Public.Participation@ecpta.co.za](mailto:Public.Participation@ecpta.co.za)

Any enquiries in connection with the notice can be directed to [Public.Participation@ecpta.co.za](mailto:Public.Participation@ecpta.co.za)

Comments received after the closing date will not be considered.



NONKQUBELA NTOMBOXOLO PIETERS  
MEMBER OF THE EXECUTIVE COUNCIL (MEC) FOR ECONOMIC DEVELOPMENT,  
ENVIRONMENTAL AFFAIRS AND TOURISM, PROVINCE OF EASTERN CAPE

**SCHEDULE**

Name of the Protected Area (section 23 (1)(b) of the National Environmental Management: Protected Areas Act, 2003 (Act No. 57 of 2003): Apiesrivier Valley Nature Reserve.

Category of Protected Area (section 23(1)(a)(i) of the National Environmental Management: Protected Areas Act, 2003 (Act No. 57 of 2003): Nature Reserve.

Assignment of Management Authority (according to section 38(2)(a) of the National Environmental Management: Protected Areas Act, 2003 (Act No. 57 of 2003): Apiesrivier Valley Holdings (Pty) Ltd (Registration Number: 2020/924696/07 ).

Description of the Protected Area: the following properties shall comprise the proposed Apiesrivier Valley Nature Reserve, as described in the schedule below:

| Apiesrivier Valley Nature Reserve |  |
|-----------------------------------|--|
| 1.                                | Portion 4 of the farm Wilde Paarde Kom No. 346, Registration Division of Graaff-Reinet, Eastern Cape Province, measuring in extent 634.0134 hectares, and held by Title Deed T17116/2022.    |
| 2.                                | Portion 1 of the farm Spring Grove No. 348, Registration Division of Graaff-Reinet, Eastern Cape Province, measuring in extent 279.1466 hectares, and held by Title Deed T17116/2022.        |
| 3.                                | Remainder of the farm The Plateau No. 350, Registration Division of Graaff-Reinet, Province of the Eastern Cape, measuring in extent 1177.8429 hectares, and held by Title Deed T17116/2022. |
| 4.                                | Portion 2 of the farm The Plateau No. 350, Registration Division of Graaff-Reinet, Province of the Eastern Cape, measuring in extent 177.5091 hectares, and held by Title Deed T17116/2022.  |
| 5.                                | Portion 3 of the farm The Plateau No. 350, Registration Division of Graaff-Reinet, Province of the Eastern Cape, measuring in extent 67.1978 hectares, and held by Title Deed T17116/2022.   |
| 6.                                | Farm No. 532, Registration Division of Graaff-Reinet, Province of the Eastern Cape, measuring in extent 631.5310 hectares, and held by Title Deed T17116/2022.                               |
| 7.                                | Farm No. 382, Registration Division of Graaff-Reinet, Province of the Eastern Cape, measuring in extent 270.6170 hectares, and held by Title Deed T17116/2022.                               |
| 8.                                | Portion 1 of the Farm No. 382, Registration Division of Graaff-Reinet, Province of the Eastern Cape, measuring in extent 232.7997 hectares, and held by Title Deed T17116/2022.              |
| 9.                                | Farm Boesmans Kloof No. 386, Registration Division of Graaff-Reinet, Province of the Eastern Cape, measuring in extent 345.3409 hectares, and held by Title Deed T17116/2022.                |
| 10.                               | Farm De Kloof No. 387, Registration Division of Graaff-Reinet, Province of the Eastern Cape, measuring in extent 146.6412 hectares, and held by Title Deed T17116/2022.                      |
| 11.                               | Farm No. 388, Registration Division of Graaff-Reinet, Province of the Eastern Cape, measuring in extent 1524.6270 hectares, and held by Title Deed T17116/2022.                              |
| 12.                               | Farm No. 389, Registration Division of Graaff-Reinet, Province of the Eastern Cape, measuring in extent 772.4419 hectares, and held by Title Deed T17116/2022.                               |

**ECONOMIC DEVELOPMENT, ENVIRONMENTAL AFFAIRS AND TOURISM FOR  
THE EASTERN CAPE PROVINCE**

**NOTICE OF INTENTION TO DECLARE A PROTECTED ENVIRONMENT IN TERMS OF THE NATIONAL  
ENVIRONMENTAL MANAGEMENT: PROTECTED AREAS ACT, 2003 (ACT 57 OF 2003)**

I, Nonkqubela Ntomboxolo Pieters, Member of the Executive Council (MEC) for Economic Development, Environmental Affairs and Tourism in the Province of the Eastern Cape, by virtue of the powers vested in me under section 32 and section 33 of the National Environmental Management: Protected Areas Act, 2003 (Act No. 57 of 2003) ("the Act"), hereby give notice of my intention to declare the properties described in the Schedule hereunder as a Protected Environment in terms of section 28(1) of the Act.

Members of the public, as well as interested and affected parties, are invited to submit written representations on or objections to the intention within 60 days after the publication of this notice in the *Gazette*, to the following address:

By Post:           The Chief Executive Officer  
                      Eastern Cape Parks and Tourism Agency  
                      P.O. Box 11235  
                      Southernwood  
                      East London  
                      5213

By Hand:          Eastern Cape Parks and Tourism Agency  
                      17-25 Oxford Street, East London CBD, 5201

By Email:          [Public.Participation@ecpta.co.za](mailto:Public.Participation@ecpta.co.za)

Any enquiries in connection with the notice can be directed to [Public.Participation@ecpta.co.za](mailto:Public.Participation@ecpta.co.za)

Comments received after the closing date will not be considered.



**NONKQUBELA NTOMBOXOLO PIETERS**

MEMBER OF THE EXECUTIVE COUNCIL (MEC) FOR ECONOMIC DEVELOPMENT, ENVIRONMENTAL  
AFFAIRS AND TOURISM, PROVINCE OF EASTERN CAPE

### **SCHEDULE**

**Name of the Protected Area** (section 28(1)(b) of the National Environmental Management: Protected Areas Act, 2003 (Act No. 57 of 2003): **Bucklands Protected Environment.**

**Category of Protected Area** (section 28(1)(a)(i) of the National Environmental Management: Protected Areas Act, 2003 (Act No. 57 of 2003): **Protected Environment.**

**Assignment of Management Authority** (according to section 38(2)(b) of the National Environmental Management: Protected Areas Act, 2003 (Act No. 57 of 2003): **Horn Bucklands Pty Ltd (Registration Number: M1952000075).**

**Description of the Protected Area:** the following properties shall comprise the proposed Bucklands Protected Environment, as described and depicted in the diagram below:

| <b>Bucklands Protected Environment</b> |  |
|--|--|
| 1.                                     | Portion 1 of the Farm Blaauw Koppen No 202, Division Steytlerville, Province of Eastern Cape, measuring 1109,4759 (One One Zero Nine Comma Four Seven Five Nine) hectares in extent and held by Deed of Transfer No. T8384/1974CTN.      |
| 2.                                     | Portion 2 of the Farm Blaauw Koppen No 202, Division of Steytlerville, Province of the Eastern Cape, measuring 170,8953 (One Seven Zero Comma Eight Nine Five Three) hectares in extent and held by Deed of Transfer No. T8384/1974CTN.  |
| 3.                                     | Portion 1 of the Farm Blaauwkop Rante No 215, Division of Steytlerville, Province of the Eastern Cape, measuring 727,2185 (Seven Two Seven Comma Two One Eight Five) hectares in extent and held by Deed of Transfer No. T8384/1974CTN.  |
| 4.                                     | Portion 1 of the Farm Groote Riviers Poort No 258, Division of Uitenhage, Province of the Eastern Cape, measuring 233,7062 (Two Three Three Comma Seven Zero Six Two) hectares in extent and held by Deed of Transfer No. T8384/1974CTN. |
| 5.                                     | The Farm Bucklands No 204, Division of Steytlerville, Province of the Eastern Cape measuring 652,7031 (Six Five Two Comma Seven Zero Three One) hectares in extent and held by Deed of Transfer No. T8384/1974CTN.                       |
| 6.                                     | The Farm Karies No 203, Division of Steytlerville, Province of the Eastern Cape measuring 2340,6421(Two Three Four Zero Comma Six Four Two One) hectares in extent and held by Deed of Transfer No. T8384/1974CTN.                       |

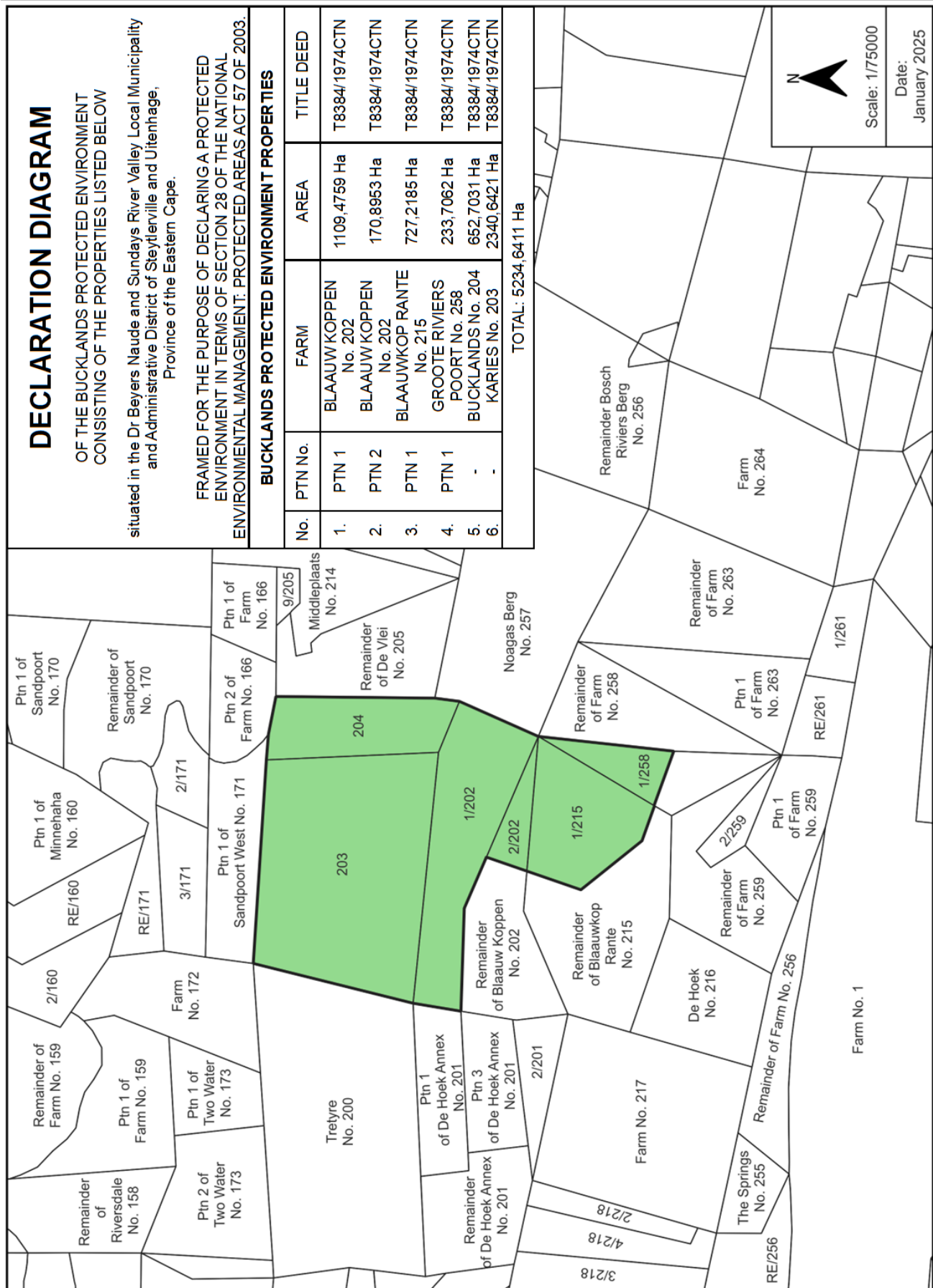

**ECONOMIC DEVELOPMENT, ENVIRONMENTAL AFFAIRS AND TOURISM FOR  
THE EASTERN CAPE PROVINCE**

**NOTICE OF INTENTION TO DECLARE A PROTECTED ENVIRONMENT IN TERMS OF THE NATIONAL  
ENVIRONMENTAL MANAGEMENT: PROTECTED AREAS ACT, 2003 (ACT 57 OF 2003)**

I, Nonkqubela Ntomboxolo Pieters, Member of the Executive Council (MEC) for Economic Development, Environmental Affairs and Tourism in the Province of the Eastern Cape, by virtue of the powers vested in me under section 32 and section 33 of the National Environmental Management: Protected Areas Act, 2003 (Act No. 57 of 2003) ("the Act"), hereby give notice of my intention to declare the properties described in the Schedule hereunder as a Protected Environment in terms of section 28(1) of the Act.

Members of the public, as well as interested and affected parties, are invited to submit written representations on or objections to the intention within 60 days after the publication of this notice in the *Gazette*, to the following address:

By Post:           The Chief Executive Officer  
                      Eastern Cape Parks and Tourism Agency  
                      P.O. Box 11235  
                      Southernwood  
                      East London  
                      5213

By Hand:          Eastern Cape Parks and Tourism Agency  
                      17-25 Oxford Street, East London CBD, 5201

By Email:          [Public.Participation@ecpta.co.za](mailto:Public.Participation@ecpta.co.za)

Any enquiries in connection with the notice can be directed to [Public.Participation@ecpta.co.za](mailto:Public.Participation@ecpta.co.za)

Comments received after the closing date will not be considered.



**NONKQUBELA NTOMBOXOLO PIETERS**

MEMBER OF THE EXECUTIVE COUNCIL (MEC) FOR ECONOMIC DEVELOPMENT, ENVIRONMENTAL  
AFFAIRS AND TOURISM, PROVINCE OF EASTERN CAPE



**SCHEDULE**

**Name of the Protected Area** (section 28(1)(b) of the National Environmental Management: Protected Areas Act, 2003 (Act No. 57 of 2003): **Faskally Protected Environment.**

**Category of Protected Area** (section 28(1)(a)(i) of the National Environmental Management: Protected Areas Act, 2003 (Act No. 57 of 2003): **Protected Environment.**

**Assignment of Management Authority** (according to section 38(2)(b) of the National Environmental Management: Protected Areas Act, 2003 (Act No. 57 of 2003): **Raymond Mark Sephton**

**Description of the Protected Area:** the following properties shall comprise the proposed Faskally Protected Environment, as described below:

| <b>Faskally Protected Environment</b> |   |
|---------------------------------------|---|
| 1.                                    | Farm Skiddaw No 5, Senqu Local Municipality in the Barkly East Registration Division, Province of the Eastern Cape, measuring in extent 559,6786 (Five Hundred and Fifty Nine comma Six Seven Eight Six) hectares, Title Deed No. T22176/1995CTN.   |
| 2.                                    | Portion 1 of the Farm Hope Town No. 41 in Barkly East Registration Division, Province of the Eastern Cape, measuring 1480,2285 hectares, Title Deed No. T22176/1995CTN.   |
| 3.                                    | Portion 3 ( a Portion of Portion 1) of the Farm Burley No 81, Senqu Local Municipality in the Barkly East Registration Division, Province of the Eastern Cape, measuring in extent 598,1360 (Five Hundred and Ninety Eight comma One Three Six Zero) hectares, Title Deed No. T96489/2006CTN. |
| 4.                                    | Remainder of Portion 2 of Farm Lauriston No 46, Senqu Local Municipality in the Barkly East Registration Division, Province of the Eastern Cape, measuring in extent 255,8415 (Two Hundred and Fifty Five comma Eight Four One Five) hectares, Title Deed No. T37296/2013CTN.                 |
| 5.                                    | Portion 4 (LAURISTON ANNEX) of the Farm Ashton No 47, Senqu Local Municipality in the Barkly East Registration Division, Province of the Eastern Cape, measuring in extent 121,0188 (One Hundred and Twenty One comma Zero One Eight Eight) hectares, Title Deed No. T37296/2013CTN.          |
| 6.                                    | Portion 3 (The Shearing Shed) the of Farm Lauriston No 46, Senqu Local Municipality in the Barkly East Registration Division, Province of the Eastern Cape, measuring in extent 1,7320 (One comma Seven Three Two Zero. hectares, Title Deed No. T37296/2013CTN.                              |
| 7.                                    | Remainder of the Farm Lauriston No 46, Senqu Local Municipality in the Barkly East Registration Division, Province of the Eastern Cape, measuring in extent 1,7131 (One comma Seven One Three One hectares, Title Deed No. T37296/2013CTN.  |

**ECONOMIC DEVELOPMENT, ENVIRONMENTAL AFFAIRS AND TOURISM FOR  
THE EASTERN CAPE PROVINCE**

**NOTICE OF INTENTION TO DECLARE A PROTECTED ENVIRONMENT IN TERMS OF THE NATIONAL  
ENVIRONMENTAL MANAGEMENT: PROTECTED AREAS ACT, 2003 (ACT 57 OF 2003)**

I, Nonkqubela Ntomboxolo Pieters, Member of the Executive Council (MEC) for Economic Development, Environmental Affairs and Tourism in the Province of the Eastern Cape, by virtue of the powers vested in me under section 32 and section 33 of the National Environmental Management: Protected Areas Act, 2003 (Act No. 57 of 2003) ("the Act"), hereby give notice of my intention to declare the properties described in the Schedule hereunder as a Protected Environment in terms of section 28(1) of the Act.

Members of the public, as well as interested and affected parties, are invited to submit written representations on or objections to the intention within 60 days after the publication of this notice in the *Gazette*, to the following address:

By Post:           The Chief Executive Officer  
                      Eastern Cape Parks and Tourism Agency  
                      P.O. Box 11235  
                      Southernwood  
                      East London  
                      5213

By Hand:          Eastern Cape Parks and Tourism Agency  
                      17-25 Oxford Street, East London CBD, 5201

By Email:          [Public.Participation@ecpta.co.za](mailto:Public.Participation@ecpta.co.za)

Any enquiries in connection with the notice can be directed to [Public.Participation@ecpta.co.za](mailto:Public.Participation@ecpta.co.za)

Comments received after the closing date will not be considered.



**NONKQUBELA NTOMBOXOLO PIETERS**

MEMBER OF THE EXECUTIVE COUNCIL (MEC) FOR ECONOMIC DEVELOPMENT, ENVIRONMENTAL  
AFFAIRS AND TOURISM, PROVINCE OF EASTERN CAPE

**SCHEDULE**

**Name of the Protected Area** (section 28(1)(b) of the National Environmental Management: Protected Areas Act, 2003 (Act No. 57 of 2003): **Haddonvale Protected Environment.**

**Category of Protected Area** (section 28(1)(a)(i) of the National Environmental Management: Protected Areas Act, 2003 (Act No. 57 of 2003): **Protected Environment.**

**Assignment of Management Authority** (according to section 38(2)(b) of the National Environmental Management: Protected Areas Act, 2003 (Act No. 57 of 2003): **Keith Stuart van Deemter (Identity Number: 6103145090086).**

**Description of the Protected Area:** the following properties shall comprise the proposed Haddonvale Protected Environment, as described and depicted in the diagram below:

| <b>Haddonvale Protected Environment</b> |  |
|---|--|
| 1.                                      | The remainder of Portion 1 of the Farm Gorie Laaghte No. 68, situated in the Division of Uitenhage, Province of the Eastern Cape, measuring 1648,9815 (One Six Four Eight Comma Nine Eight One Five) hectares in extent and held by Deed of Transfer No. T16913/1985CTN. |

(Sgd) Max Jurisch.  
Examiner.

| Sides.     | Angles.     |
|------------|-------------|
| AB 609.82  | A 43.53.40  |
| BC 520.54  | B 228.11.50 |
| CD 587.84  | C 114.15.30 |
| DE 1184.70 | D 111.14.30 |
| EF 418.90  | E 147.13.50 |
| FA 1929.13 | F 75.10.40  |

| Co-ordinates.         |
|-----------------------|
| A + 1527.72 + 1072.16 |
| B + 919.17 + 1092.83  |
| C + 547.90 + 1397.68  |
| D 0 0 1184.70         |
| E 0 0 0               |
| F + 226.73 - 352.23   |

The numerical data of the fig. for transfer and the fig. as per existing beacons, are co-incident.

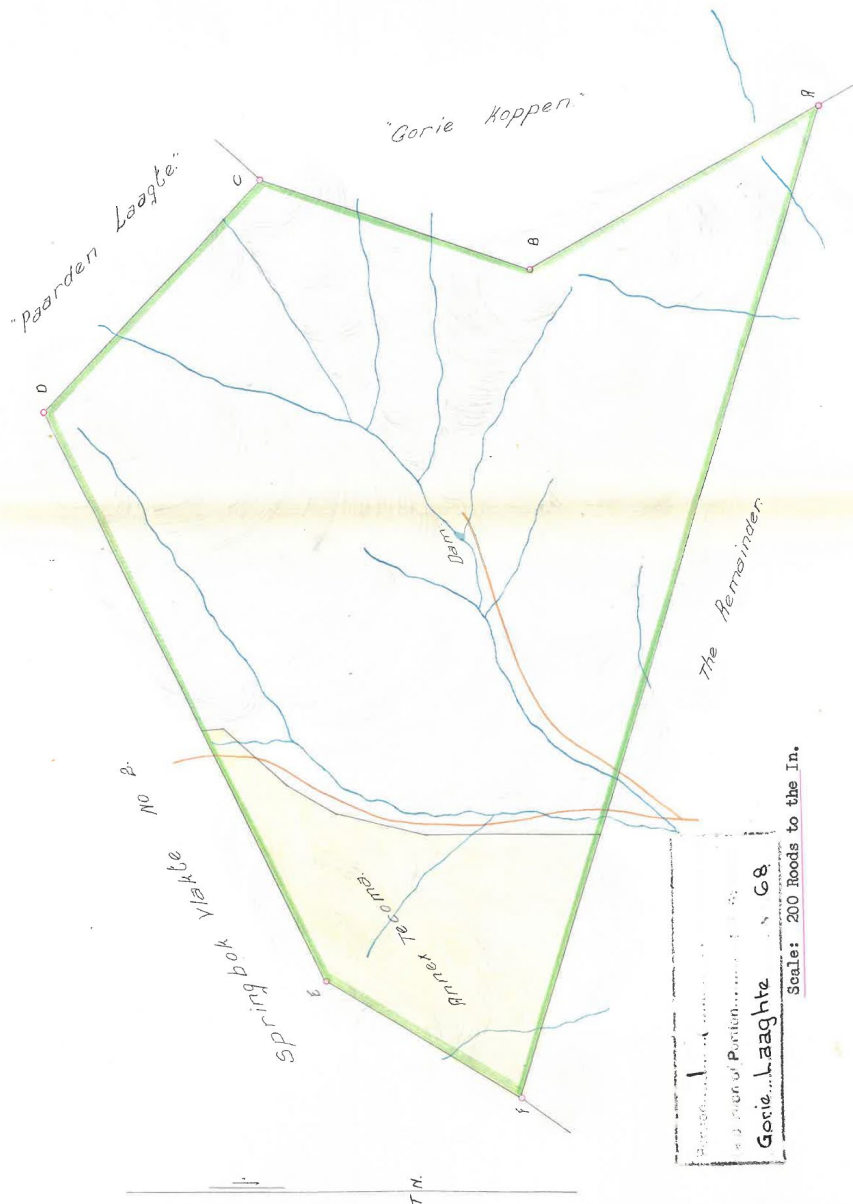

The above diagram Lett. A. to F. represents 2284 Morgen 3/4 Square Rods of land, being One Half of the farm "GORIE LAAGTE", granted in quitrent to Ben Rudman and Alje J. van der Merwe on the 25th April, 1887. Situate in the Division of Uitenhage, Fieldcornetcy of Great Winterhoek.

Bounded on the NE by Paarden laagte.

E " Gorie koppen,  
S " the Reminders, and  
W and NW by Springboklaakte No.2.

By me, (Sgd) A.M. Melvill.  
Govt. Surveyor.  
1887.

Transfer --- 209  
19th October, 1887.

Alje J. van Deemter.

*Alje J. van Deemter*

Sheet BN - 4D

**ECONOMIC DEVELOPMENT, ENVIRONMENTAL AFFAIRS AND TOURISM FOR  
THE EASTERN CAPE PROVINCE**

**NOTICE OF INTENTION TO DECLARE A NATURE RESERVE IN TERMS OF THE NATIONAL  
ENVIRONMENTAL MANAGEMENT: PROTECTED AREAS ACT, 2003 (ACT 57 OF 2003)**

I, Nonkqubela Ntomboxolo Pieters, Member of the Executive Council (MEC) for Economic Development, Environmental Affairs and Tourism in the Province of the Eastern Cape, by virtue of the powers vested in me under section 32 and section 33 of the National Environmental Management: Protected Areas Act, 2003 (Act No. 57 of 2003) ("the Act"), hereby give notice of my intention to declare the properties described in the Schedule hereunder as a Nature Reserve in terms of section 23(1) of the Act.

Members of the public, as well as interested and affected parties, are invited to submit written representations on or objections to the intention within 60 days after the publication of this notice in the *Gazette*, to the following address:

By Post: The Chief Executive Officer  
Eastern Cape Parks and Tourism Agency  
P.O. Box 11235  
Southernwood  
East London  
5213

By Hand: Eastern Cape Parks and Tourism Agency  
17-25 Oxford Street, East London CBD, 5201

By Email: [Public.Participation@ecpta.co.za](mailto:Public.Participation@ecpta.co.za)

Any enquiries in connection with the notice can be directed to [Public.Participation@ecpta.co.za](mailto:Public.Participation@ecpta.co.za)

Comments received after the closing date will not be considered.



**NONKQUBELA NTOMBOXOLO PIETERS**

MEMBER OF THE EXECUTIVE COUNCIL (MEC) FOR ECONOMIC DEVELOPMENT, ENVIRONMENTAL  
AFFAIRS AND TOURISM, PROVINCE OF EASTERN CAPE

### **SCHEDULE**

**Name of the Protected Area** (section 23(1)(b) of the National Environmental Management: Protected Areas Act, 2003 (Act No. 57 of 2003): **Joubertskraal Nature Reserve**

**Category of Protected Area** (section 23(1)(a)(i) of the National Environmental Management: Protected Areas Act, 2003 (Act No. 57 of 2003): **Nature Reserve**.

**Assignment of Management Authority** (according to section 38(2)(b) of the National Environmental Management: Protected Areas Act, 2003 (Act No. 57 of 2003): **Anton Murray Boonzaier** (Identity No. 6501245042081).

**Description of the Protected Area:** the following properties shall comprise the proposed Joubertskraal Nature Reserve, as depicted in the diagram below:

| <b>Joubertskraal Nature Reserve</b> |   |
|-------------------------------------|---|
| 1.                                  | The Farm Jouberts Kraal No 109, situated in the area of the Kou-Kamma Municipality, Division Humansdorp, Province of the Eastern Cape, measuring 1498,4528 (One Thousand Four Hundred and Ninety Eight Comma Four Five Two Eight) hectares in extent and held by Deed of Transfer No. T57803/2004CTN. |

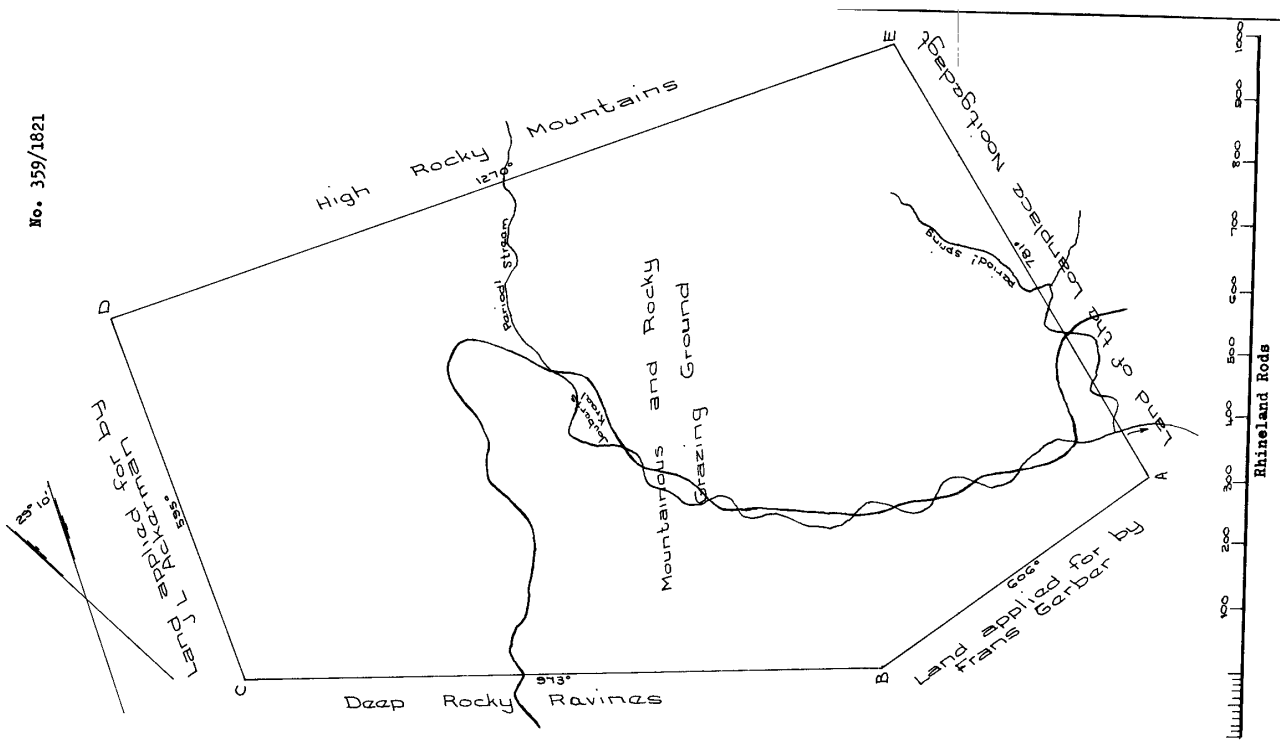

The Farm.....No. 102.....  
HUMANSDORP

The Diagram A - E represents 1749 Morgens 265 Square Rods of land situate in the District of Uitenhage applied for by Ignatius Petrus Duprez

Extending Ely. to the land of the Farm Mooitgedagt  
N. towards the Baviaanskloof Mountains  
W. towards the Doornboom and  
S. towards Vacant Land and the farm Zevenfontein

Surveyed by me  
(Sgd.) J. Knaebel  
Snn. Surveyor  
1821

Copied from diagram relating  
to Title..... Deed No. 6-17  
dated..... 20.10.1826  
for Survey-General  
..... 26.5.1970

SHEET EM-7A OS

**ECONOMIC DEVELOPMENT, ENVIRONMENTAL AFFAIRS AND TOURISM FOR  
THE EASTERN CAPE PROVINCE**

**NOTICE OF INTENTION TO DECLARE A PROTECTED ENVIRONMENT IN TERMS OF THE NATIONAL  
ENVIRONMENTAL MANAGEMENT: PROTECTED AREAS ACT, 2003 (ACT 57 OF 2003)**

I, Nonkqubela Ntomboxolo Pieters, Member of the Executive Council (MEC) for Economic Development, Environmental Affairs and Tourism in the Province of the Eastern Cape, by virtue of the powers vested in me under section 32 and section 33 of the National Environmental Management: Protected Areas Act, 2003 (Act No. 57 of 2003) ("the Act"), hereby give notice of my intention to declare the properties described in the Schedule hereunder as a Protected Environment in terms of section 28(1) of the Act.

Members of the public, as well as interested and affected parties, are invited to submit written representations on or objections to the intention within 60 days after the publication of this notice in the *Gazette*, to the following address:

By Post:           The Chief Executive Officer  
                      Eastern Cape Parks and Tourism Agency  
                      P.O. Box 11235  
                      Southernwood  
                      East London  
                      5213

By Hand:          Eastern Cape Parks and Tourism Agency  
                      17-25 Oxford Street, East London CBD, 5201

By Email:          [Public.Participation@ecpta.co.za](mailto:Public.Participation@ecpta.co.za)

Any enquiries in connection with the notice can be directed to [Public.Participation@ecpta.co.za](mailto:Public.Participation@ecpta.co.za)

Comments received after the closing date will not be considered.



**NONKQUBELA NTOMBOXOLO PIETERS**

MEMBER OF THE EXECUTIVE COUNCIL (MEC) FOR ECONOMIC DEVELOPMENT, ENVIRONMENTAL  
AFFAIRS AND TOURISM, PROVINCE OF EASTERN CAPE



**SCHEDULE**

**Name of the Protected Area** (section 28(1)(b) of the National Environmental Management: Protected Areas Act, 2003 (Act No. 57 of 2003): **Kleinpoort Protected Environment.**

**Category of Protected Area** (section 28(1)(a)(i) of the National Environmental Management: Protected Areas Act, 2003 (Act No. 57 of 2003): **Protected Environment.**

**Assignment of Management Authority** (according to section 38(2)(b) of the National Environmental Management: Protected Areas Act, 2003 (Act No. 57 of 2003): **Patrick Beresford Grewar (Identity Number: 570819 5118 081).**

**Description of the Protected Area:** the following properties shall comprise the proposed Kleinpoort Protected Environment, as described and depicted in the diagram below:

| <b>Kleinpoort Protected Environment</b> |  |
|---|--|
| 1.                                      | Remainder of the Farm Klein Poort East No 10, Division of Uitenhage, Province of the Eastern Cape, measuring 931,0557 (Nine Three One Comma Zero Five Five Seven) hectares in extent and held by Deed of Transfer No. T75527/1994CTN.                          |
| 2.                                      | Remainder of Portion 4 (Klein Poort East) of the Farm Klein Poort No 11, Division of Uitenhage, Province of the Eastern Cape, measuring 343,1561 (Three Four Three Comma One Five Six One) hectares in extent and held by Deed of Transfer No. T75527/1994CTN. |
| 3.                                      | Remainder of Portion 1 of the Farm Matjesgoed Fontein No 61, Division of Uitenhage, Province of the Eastern Cape, measuring 50,3598 (Five Zero Comma Three Five Nine Eight) hectares in extent and held by Deed of Transfer No. T75527/1994CTN.                |
| 4.                                      | Remainder of the Farm Paarden Laaghte No 62, Division of Uitenhage, Province of the Eastern Cape, measuring 1489,5202 (One Four Eight Nine Comma Five Two Zero Two) hectares in extent and held by Deed of Transfer No. T25008/1986CTN.                        |

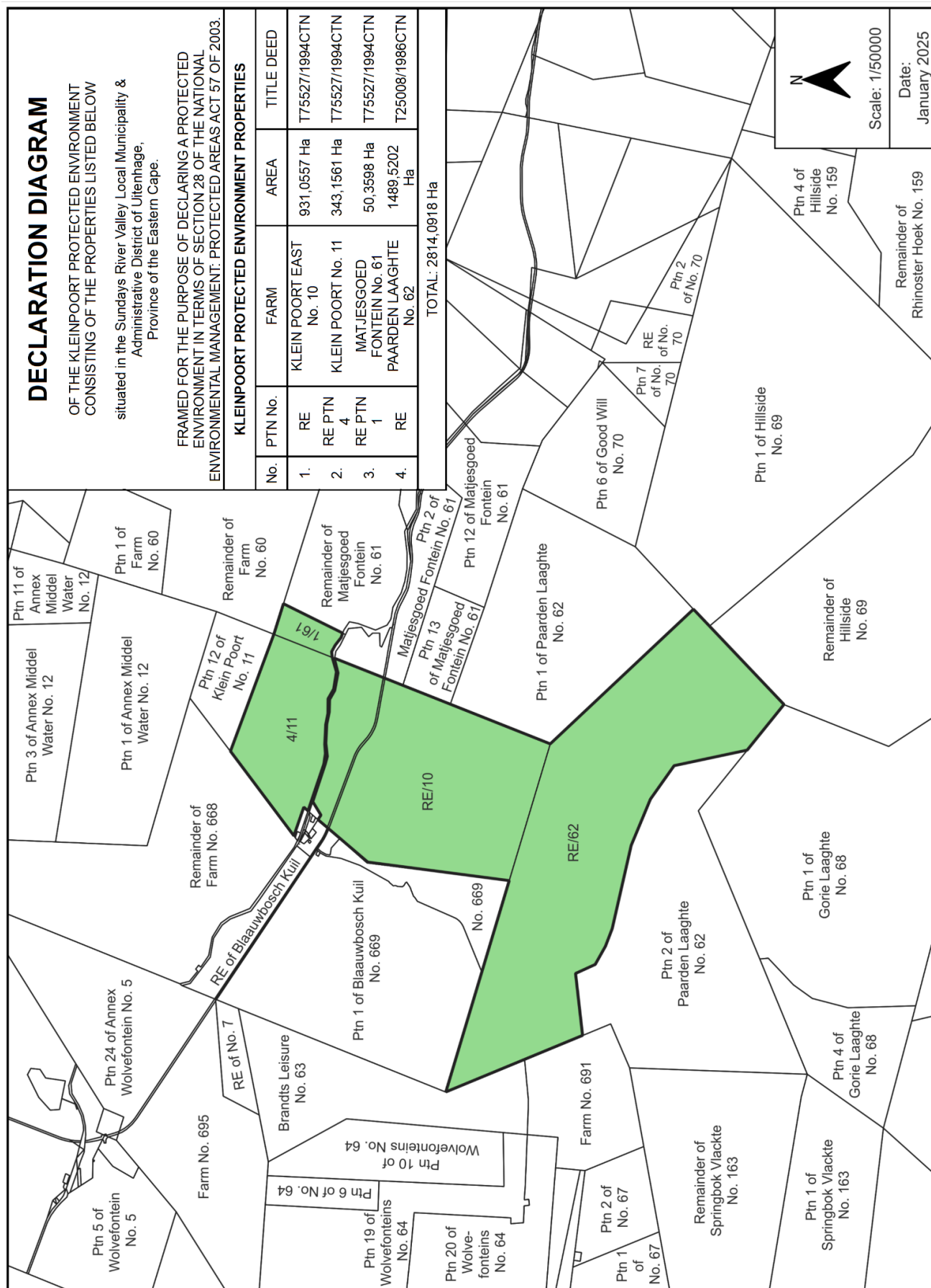

**ECONOMIC DEVELOPMENT, ENVIRONMENTAL AFFAIRS AND TOURISM FOR  
THE EASTERN CAPE PROVINCE**

**NOTICE OF INTENTION TO DECLARE A NATURE RESERVE IN TERMS OF THE NATIONAL  
ENVIRONMENTAL MANAGEMENT: PROTECTED AREAS ACT, 2003 (ACT 57 OF 2003)**

I, Nonkqubela Ntomboxolo Pieters, Member of the Executive Council (MEC) for Economic Development, Environmental Affairs and Tourism in the Province of the Eastern Cape, by virtue of the powers vested in me under section 32 and section 33 of the National Environmental Management: Protected Areas Act, 2003 (Act No. 57 of 2003) ("the Act"), hereby give notice of my intention to declare the properties described in the Schedule hereunder as a Nature Reserve in terms of section 23(1) of the Act.

Members of the public, as well as interested and affected parties, are invited to submit written representations on or objections to the intention within 60 days after the publication of this notice in the *Gazette*, to the following address:

By Post:           The Chief Executive Officer  
                      Eastern Cape Parks and Tourism Agency  
                      P.O. Box 11235  
                      Southernwood  
                      East London  
                      5213

By Hand:          Eastern Cape Parks and Tourism Agency  
                      17-25 Oxford Street, East London CBD, 5201

By Email:         [Public.Participation@ecpta.co.za](mailto:Public.Participation@ecpta.co.za)

Any enquiries in connection with the notice can be directed to [Public.Participation@ecpta.co.za](mailto:Public.Participation@ecpta.co.za)

Comments received after the closing date will not be considered.



**NONKQUBELA NTOMBOXOLO PIETERS**

MEMBER OF THE EXECUTIVE COUNCIL (MEC) FOR ECONOMIC DEVELOPMENT, ENVIRONMENTAL  
AFFAIRS AND TOURISM, PROVINCE OF EASTERN CAPE

### **SCHEDULE**

**Name of the Protected Area** (section 23 (1)(b) of the National Environmental Management: Protected Areas Act, 2003 (Act No. 57 of 2003): **Noagasberg Nature Reserve.**

**Category of Protected Area** (section 23(1)(a)(i) of the National Environmental Management: Protected Areas Act, 2003 (Act No. 57 of 2003): **Nature Reserve.**

**Assignment of Management Authority** (according to section 38(2)(a) of the National Environmental Management: Protected Areas Act, 2003 (Act No. 57 of 2003): **Johan Albertus Rypma (Netherlands Passport No.: BY5H04FL5).**

**Description of the Protected Area:** the following properties shall comprise the proposed Noagasberg Nature Reserve, as depicted in the diagram below:

| <b>Noagasberg Nature Reserve</b> |   |
|----------------------------------|---|
| 1.                               | The Farm Noagas Berg No 257, Division of Uitenhage, Province of the Eastern Cape, measuring 2124,5834 (Two One Two Four Comma Five Eight Three Four) hectares in extent and held by Deed of Transfer No. T17891/2019. |

NO. B. 247/1899.  
The numerical data of this diagram are sufficiently consistent.  
(Sgt.) J. J. Bosman,  
Examiner.



| Sides.     | Angles.     |
|------------|-------------|
| AB 598.97  | A 95. 7.10  |
| BC 178.71  | B 195.12. 0 |
| AC 1539.30 | C 82.32.20  |
| DE 1220.02 | D 86. 9.40  |
| EF 944.70  | E 75. 1. 0  |
| FA 636.86  | F 185.57.50 |

| Co-ordinates          |
|-----------------------|
| A - 2047.93 + 9039.32 |
| B - 1837.59 + 9600.15 |
| C - 1820.90 + 9778.08 |
| D - 319.97 + 9136.56  |
| E - 669.69 + 8267.74  |
| F - 1475.96 + 8763.35 |

T. Noagas Berg 257

Scale of Cape Roads.

The figure A.B.C.D.E.F. represents 2480 Morgen and 269 Square Rods of land being the farm "Noagas's Berg", situate in the Fieldcorner of Great-Winterhoek West, Division of Uitenhage.

Bounded N.N.E. by Noagas.  
E.S.E. " Bosch Riviers Berg.  
S.S.W. " Noagas-Berg No.2 & Groote Riviers Poort  
No.2 and  
W. & W.N.W. by Blaauwkoppen & Bucklands.

Surveyed by me

(Sgt.) Roger Restall.  
Government Surveyor.  
June 1899.

Beacons E.F. were pointed out to Fieldcorner S.P. Ferreira of Klands River.  
Beacon D is a high perpendicular Rock at the entrance of the Kloof.  
(Int.) R. R.

Sheet BM-68, 6A.

Title Mit.Q.20-15  
dated 23.3.1903  
13.9.1961  
CHECKED DATA CHECKED

MA/78

**ECONOMIC DEVELOPMENT, ENVIRONMENTAL AFFAIRS AND TOURISM FOR  
THE EASTERN CAPE PROVINCE**

**NOTICE OF INTENTION TO DECLARE A PROTECTED ENVIRONMENT IN TERMS OF THE NATIONAL  
ENVIRONMENTAL MANAGEMENT: PROTECTED AREAS ACT, 2003 (ACT 57 OF 2003)**

I, Nonkqubela Ntomboxolo Pieters, Member of the Executive Council (MEC) for Economic Development, Environmental Affairs and Tourism in the Province of the Eastern Cape, by virtue of the powers vested in me under section 32 and section 33 of the National Environmental Management: Protected Areas Act, 2003 (Act No. 57 of 2003) ("the Act"), hereby give notice of my intention to declare the properties described in the Schedule hereunder as a Protected Environment in terms of section 28(1) of the Act.

Members of the public, as well as interested and affected parties, are invited to submit written representations on or objections to the intention within 60 days after the publication of this notice in the *Gazette*, to the following address:

By Post:           The Chief Executive Officer  
                      Eastern Cape Parks and Tourism Agency  
                      P.O. Box 11235  
                      Southernwood  
                      East London  
                      5213

By Hand:          Eastern Cape Parks and Tourism Agency  
                      17-25 Oxford Street, East London CBD, 5201

By Email:          [Public.Participation@ecpta.co.za](mailto:Public.Participation@ecpta.co.za)

Any enquiries in connection with the notice can be directed to [Public.Participation@ecpta.co.za](mailto:Public.Participation@ecpta.co.za)

Comments received after the closing date will not be considered.



**HON. MS. NONKQUBELA NTOMBOXOLO PIETERS**

MEMBER OF THE EXECUTIVE COUNCIL (MEC) FOR ECONOMIC DEVELOPMENT, ENVIRONMENTAL  
AFFAIRS AND TOURISM, PROVINCE OF EASTERN CAPE

**SCHEDULE**

**Name of the Protected Area** (section 28(1)(b) of the National Environmental Management: Protected Areas Act, 2003 (Act No. 57 of 2003): **Wolvekloof Protected Environment.**

**Category of Protected Area** (section 28(1)(a)(i) of the National Environmental Management: Protected Areas Act, 2003 (Act No. 57 of 2003): **Protected Environment.**

**Assignment of Management Authority** (according to section 38(2)(b) of the National Environmental Management: Protected Areas Act, 2003 (Act No. 57 of 2003): **SimSo Wildlife (Pty) Ltd (Registration Number: 2022/592674/07).**

**Description of the Protected Area:** the following properties shall comprise the proposed Wolvekloof Protected Environment, as depicted in the diagram below:

| <b>Wolvekloof Protected Environment</b> |   |
|---|---|
| 1.                                      | Remainder of the farm Melkhoutbosch No. 345, in the Kouga Local Municipality, Division of Humansdorp, Province of the Eastern Cape. In extent 256,9596 (Two Hundred and Fifty-Six comma Nine Five Nine Six) hectares, held by Deed of Transfer No. T73565/2003 and shown in SG Diagram No. B2990/1907.              |
| 2.                                      | Portion 4 (Wolvekloof) of the farm Melkhoutbosch No. 345, in the Kouga Local Municipality, Division of Humansdorp, Province of the Eastern Cape. In extent 455,2582 (Four Hundred and Fifty-Five comma Two Five Eight Two) hectares, held by Deed of Transfer No. T73565/2003 and shown in SG Diagram No. 938/1908. |
| 3.                                      | Portion 7 (a portion of Portion 3) of the farm Misgund No. 341, in the Kouga Local Municipality, Division of Humansdorp, Province of the Eastern Cape. In extent 1,8836 (One comma Eight Eight Three Six) hectares, held by Deed of Transfer No. T73565/2003 and shown in SG Diagram No. A3659/1923.                |

**DECLARATION DIAGRAM**  
OF THE WOLVEKLOOF PROTECTED ENVIRONMENT  
CONSISTING OF THE PROPERTIES LISTED BELOW

situated in the Kouga Local Municipality &  
Administrative District of Humansdorp,  
Province of the Eastern Cape.

FRAMED FOR THE PURPOSE OF DECLARING A  
PROTECTED ENVIRONMENT IN TERMS OF SECTION 28  
OF THE NATIONAL ENVIRONMENTAL MANAGEMENT  
PROTECTED AREAS ACT 57 OF 2003.

| WOLVEKLOOF PROTECTED ENVIRONMENT<br>PROPERTIES |         |                            |             |             |
|--|---------|----------------------------|-------------|-------------|
| No.  | PTN No. | FARM                       | AREA        | TITLE DEED  |
| 1.   | -       | RE / Melkhoutbosch No. 345 | 256,9596 Ha | T73565/2003 |
| 2.   | Ptn 4   | Melkhoutbosch No. 345      | 455,2582 Ha | T73565/2003 |
| 3.   | Ptn 7   | Melkhoutbosch No. 341      | 1,8836 Ha   | T73565/2003 |
| TOTAL: 714,1014 Ha                             |         |                            |             |             |

Remainder of Ptn 5 of Zwartebosch No. 347

Remainder of Ptn 32 of Zwartebosch No. 347

Remainder of Ptn 5 of Melkhoutbosch No. 341

Ptn 1 of Melkhoutbosch No. 345

Ptn 2 of Melkhoutbosch No. 345

Ptn 3 of Melkhoutbosch No. 345

Ptn 4 of Melkhoutbosch No. 345

Ptn 5 of Melkhoutbosch No. 345

Ptn 6 of Melkhoutbosch No. 345

Ptn 7 of Melkhoutbosch No. 345

Ptn 8 of Melkhoutbosch No. 345

Ptn 9 of Melkhoutbosch No. 345

Ptn 10 of Melkhoutbosch No. 345

Ptn 11 of Melkhoutbosch No. 345

Ptn 12 of Melkhoutbosch No. 345

Ptn 13 of Melkhoutbosch No. 345

Ptn 14 of Melkhoutbosch No. 345

Ptn 15 of Melkhoutbosch No. 345

Ptn 16 of Melkhoutbosch No. 345

Ptn 17 of Melkhoutbosch No. 345

Ptn 18 of Melkhoutbosch No. 345

Ptn 19 of Melkhoutbosch No. 345

Ptn 20 of Melkhoutbosch No. 345

Ptn 21 of Melkhoutbosch No. 345

Ptn 22 of Melkhoutbosch No. 345

Ptn 23 of Melkhoutbosch No. 345

Ptn 24 of Melkhoutbosch No. 345

Ptn 25 of Melkhoutbosch No. 345

Ptn 26 of Melkhoutbosch No. 345

Ptn 27 of Melkhoutbosch No. 345

Ptn 28 of Melkhoutbosch No. 345

Ptn 29 of Melkhoutbosch No. 345

Ptn 30 of Melkhoutbosch No. 345

Ptn 31 of Melkhoutbosch No. 345

Ptn 32 of Melkhoutbosch No. 345

Ptn 33 of Melkhoutbosch No. 345

Ptn 34 of Melkhoutbosch No. 345

Ptn 35 of Melkhoutbosch No. 345

Ptn 36 of Melkhoutbosch No. 345

Ptn 37 of Melkhoutbosch No. 345

Ptn 38 of Melkhoutbosch No. 345

Ptn 39 of Melkhoutbosch No. 345

Ptn 40 of Melkhoutbosch No. 345

Ptn 41 of Melkhoutbosch No. 345

Ptn 42 of Melkhoutbosch No. 345

Ptn 43 of Melkhoutbosch No. 345

Ptn 44 of Melkhoutbosch No. 345

Ptn 45 of Melkhoutbosch No. 345

Ptn 46 of Melkhoutbosch No. 345

Ptn 47 of Melkhoutbosch No. 345

Ptn 48 of Melkhoutbosch No. 345

Ptn 49 of Melkhoutbosch No. 345

Ptn 50 of Melkhoutbosch No. 345

Ptn 51 of Melkhoutbosch No. 345

Ptn 52 of Melkhoutbosch No. 345

Ptn 53 of Melkhoutbosch No. 345

Ptn 54 of Melkhoutbosch No. 345

Ptn 55 of Melkhoutbosch No. 345

Ptn 56 of Melkhoutbosch No. 345

Ptn 57 of Melkhoutbosch No. 345

Ptn 58 of Melkhoutbosch No. 345

Ptn 59 of Melkhoutbosch No. 345

Ptn 60 of Melkhoutbosch No. 345

Ptn 61 of Melkhoutbosch No. 345

Ptn 62 of Melkhoutbosch No. 345

Ptn 63 of Melkhoutbosch No. 345

Ptn 64 of Melkhoutbosch No. 345

Ptn 65 of Melkhoutbosch No. 345

Ptn 66 of Melkhoutbosch No. 345

Ptn 67 of Melkhoutbosch No. 345

Ptn 68 of Melkhoutbosch No. 345

Ptn 69 of Melkhoutbosch No. 345

Ptn 70 of Melkhoutbosch No. 345

Ptn 71 of Melkhoutbos









Printed by and obtainable from the Government Printer, Bosman Street, Private Bag X85, Pretoria, 0001.  
Contact Centre Tel: 012-748 6200. eMail: [info.egazette@gpw.gov.za](mailto:info.egazette@gpw.gov.za)  
Also available at the Legal Advisory Services, **Province of the Eastern Cape**, Private Bag X0047, Bisho, 5605.  
Tel. (040) 635-0052.